

2012 Winter Specials

25% OFF* **20% Deposit** by March 31, 2012
Delivery by July 31, 2012

Swiftwater

Franklin



\$41,960

1,140 Sq. Ft. • 24' x 32' • 2 Bedrooms • Loft • 1 Bath

Covered Porch
Deck

Retails at
\$55,951
You SAVE
\$13,991



\$42,999

960 Sq. Ft. • 24' x 40' • 3 Bedrooms • 1 Bath • Covered Porch

Retails at
\$57,350
You SAVE
\$14,351

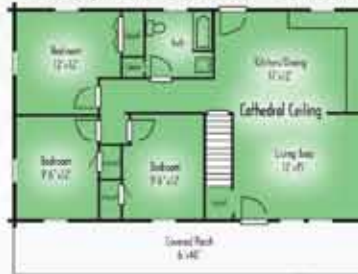

Clearwater

Grand View



\$59,850

1,586 Sq. Ft. • 26' x 36' • 3 Bedrooms • Loft • 2.5 Baths

Covered Porch

Retails at
\$79,804
You SAVE
\$19,954



\$104,100

3 Bedrooms • Loft • 2 Baths
Covered Wrap Porch



Retails at
\$138,800 You SAVE
\$34,700



COVENTRY LOG HOMES, INC.

*Complete Packages Only

108 South Court Street Woodsville, NH 03785 | 1-800-308-7505 (Toll Free) | 1-603-747-8177
 Fax: 1-603-747-3340 | info@coventryloghomes.com | www.coventryloghomes.com



Winter/Spring Specials

2012 Early Delivery Specials

1. Take delivery or pay in full in **February** 2012. 2. Take delivery or pay in full in **March** 2012.
–Receive a **17%** discount off your pkg. price. –Receive a **15%** discount off your pkg. price.
OR Place *order deposit in February for **15%** off. **OR** Place *order deposit in March for **12%** off.
3. Take delivery or pay in full in **April** 2012.
–Receive a **12%** discount off your pkg. price.
OR Place *order deposit in April for **10%** off.

—No other discounts apply—8x8 upgrade at 50% Off can be used in conjunction with this offer!

Ask your representative for details.

Delivery dates are subject to availability and are on a first-come, first-served basis.

Discounts Apply Only to Price List Dated October 1, 2011.

**Order deposit is 20% of package price • To qualify for discounts delivery must take place by July 31, 2012 at the latest*

8x8 LOG UPGRADE OFFER good starting October 1, 2011

–Take **50%** 8x8 “D” Log Upgrade
discount off your 8x8 upgrade pkg. price
discount not available for Recreational Camp Series

TOP 10 Reasons to Buy From CLH

- 1. Factory Direct —**
 - We Cut Out the Middlemen to Pass On Huge Factory Direct Savings
- 2. Top Quality Materials —**
 - Andersen Windows and Patio Doors
 - Advantech Subfloors
 - Therma Tru Fiberglass Doors
- 3. Kiln-Dried Logs —**
 - 19% or Less Average Moisture Content
- 4. Graded Logs —**
 - We are a member of Log Home Council Grading Program
- 5. Pre-Cut Logs —**
 - Pre-Cutting Saves You Time and Most Importantly Money
- 6. Shipping Charges —**
 - \$1.00 Shipping in Eastern and Central Time Zones
- 7. Price Guarantee —**
 - We Beat Anyone, Anytime With a Better More Complete Package
- 8. Free Custom Design & Price Estimates —**
 - We Turn Around a Fast, Accurate Quote
- 9. Family Owned and Operated —**
 - Our Family has Been Selling & Building Log Homes for Over 30 Years
- 10. Our People —**
 - Our Team of Professionals are Good at What They Do and are Here to Help from Design to Finished Home

